

Pine

4 Bedrooms / 3.5 Baths

2,021 sq ft



Unit AA1



Unit AA2



Unit AA3



*Information believed accurate but not warranted. All drawings and elevation renderings are artistic representations only. Floor plan details & final decisions to be made by Kerley Family Homes. This document is for informational purposes only and is subject to change without notice. Please contact onsite agent for details regarding availability, lots and options. Updated 06/04/20.

KerleyFamilyHomes.com

Information believed accurate but not warranted. Prices and offer subject to change without prior notice.



Pine

4 Bedrooms / 3.5 Baths

2,021 sq ft



Basement Floor

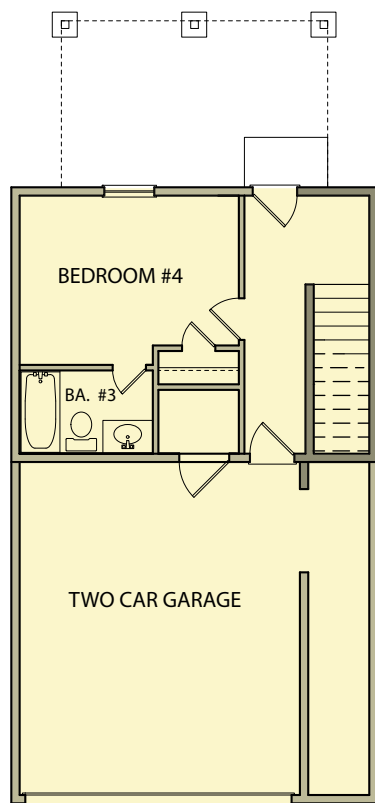

First Floor

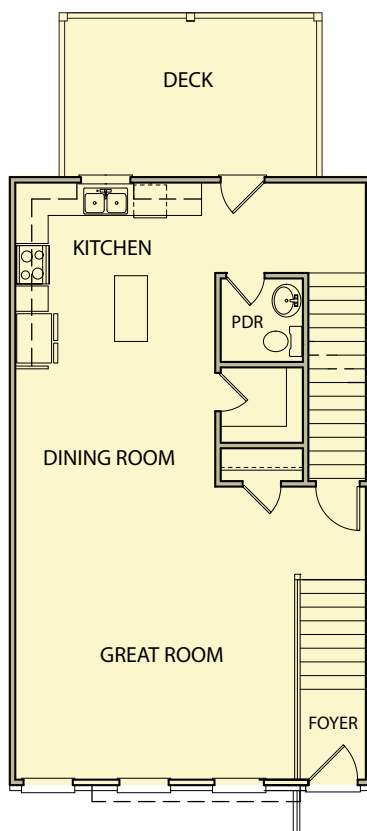

Second Floor

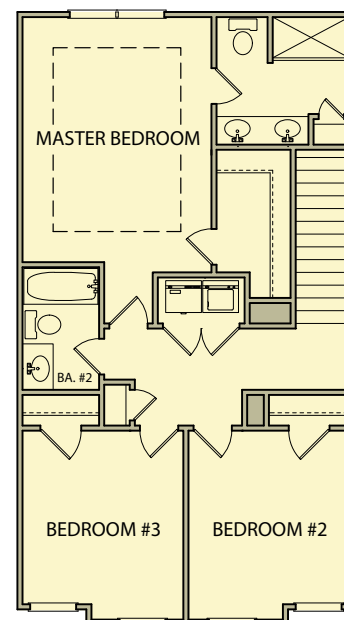

Opt. Covered Porch

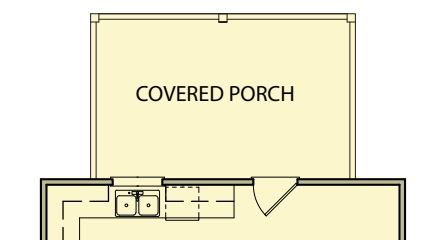

*Information believed accurate but not warranted. All drawings and elevation renderings are artistic representations only. Floor plan details & final decisions to be made by Kerley Family Homes. This document is for informational purposes only and is subject to change without notice. Please contact onsite agent for details regarding availability, lots and options. Updated 06/04/20.