

# Abigail

4 Bedrooms / 2.5 Baths

1,971 sq ft



Elevation AA



Elevation BB



Elevation CC



Floor plan details & final decisions to be decided by Kerley Family Homes. This is for information purposes only. Please contact onsite agent for details regarding availability, lots, & options. Updated 7/30/18

[KerleyFamilyHomes.com](http://KerleyFamilyHomes.com)

Information believed accurate but not warranted. Prices and offer subject to change without prior notice.



# Abigail

4 Bedrooms / 2.5 Baths

1,971 sq ft



First Floor

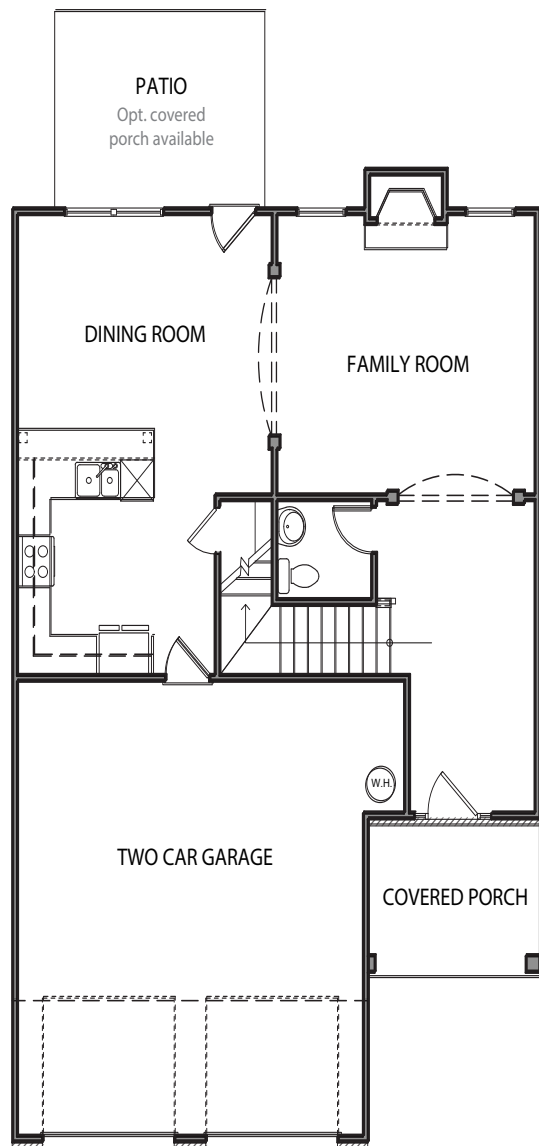

Second Floor

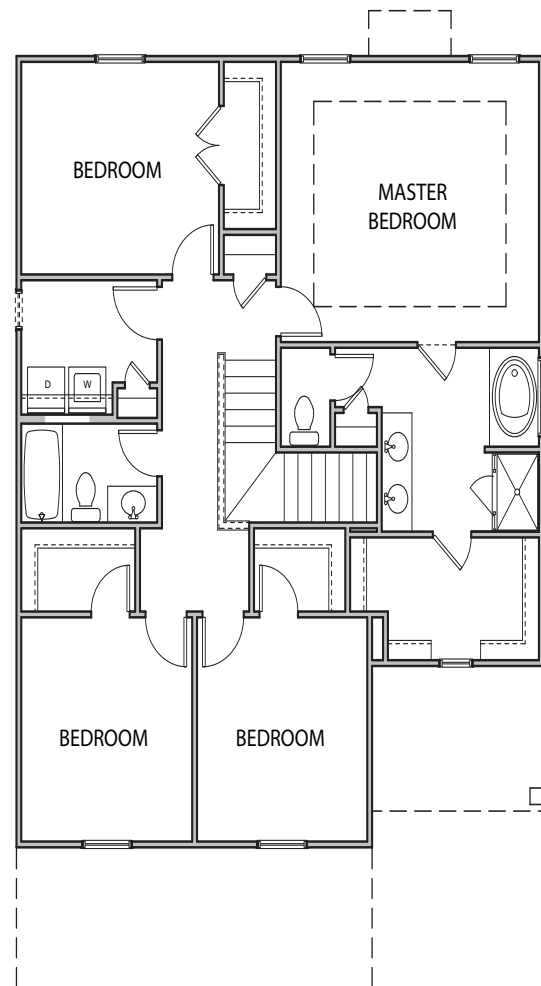

Opt. Partial Covered Porch

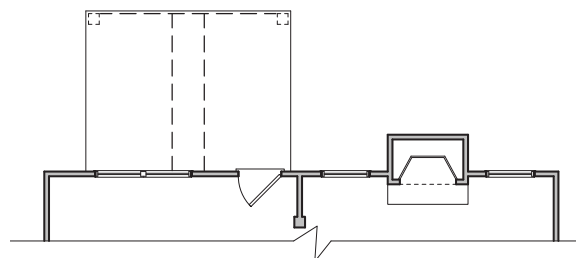

Floor plan details & final decisions to be decided by Kerley Family Homes. This is for information purposes only. Please contact onsite agent for details regarding availability, lots, & options. Updated 7/30/18

[KerleyFamilyHomes.com](http://KerleyFamilyHomes.com)

Information believed accurate but not warranted. Prices and offer subject to change without prior notice.

